



ASSEMBLY INSTRUCTION

TILLEY FABRIC - CORNER LOUNGE WITH OTTOMAN

ITEM CODE : 83396

Imported by Amart Furniture Pty Ltd, Qld, Brisbane Australia.
For any assistance with assembly or for missing parts please
phone Amart Furniture, Customer Service Free call 1800 351 084

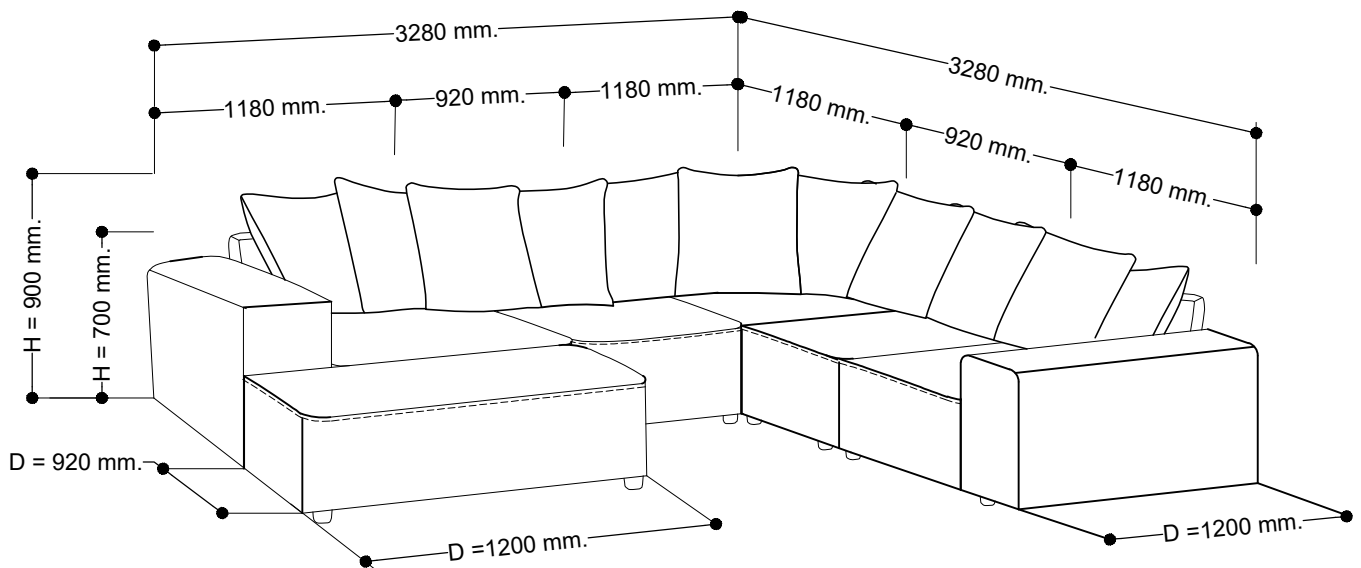
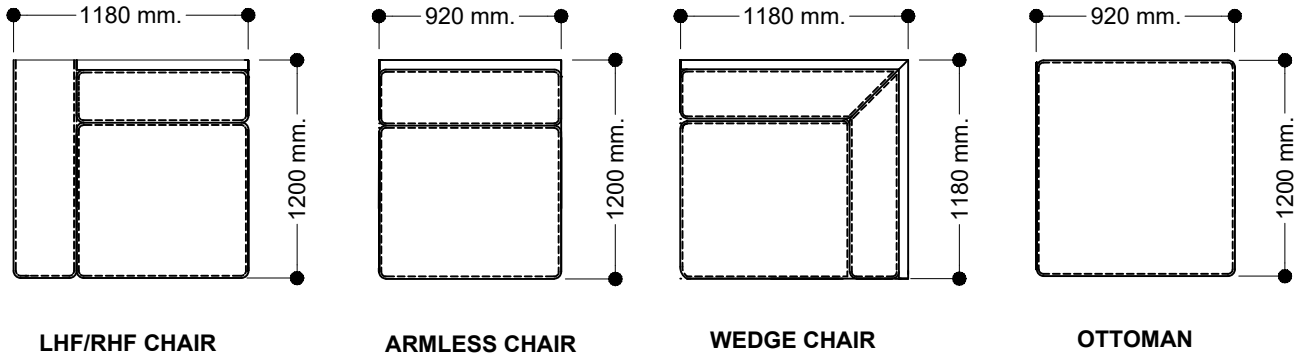



Imported by Amart Furniture Pty Ltd, Qld, Brisbane Australia.
For any assistance with assembly or for missing parts please phone
Amart Furniture, Customer Service Free call 1800 351 084

PRE-ASSEMBLY PREPARATION

Before you start :

1. Choose a clean, level, spacious assembly area. Avoid hard surfaces that may damage the product.
2. Take care when lifting. Product should be assembled as near as possible to the point of use.
3. Ensure that you have all required contents for complete assembly.
4. Always read the assembly instructions carefully before beginning assembly.
5. Keep all hardware parts and packaging out of reach of small children.
6. Do not over-tighten the screws bolts as this may damage the threads.

	
ALLOW 20 MINUTES	2 PEOPLE REQUIRED

PARTS LIST

A : BOLT M8 x 65 mm

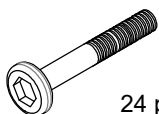

24 pcs.

B : Hexagon key M5



6 pcs.

C : FEET

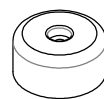

24 pcs.

① : LHF/RHF CHAIR

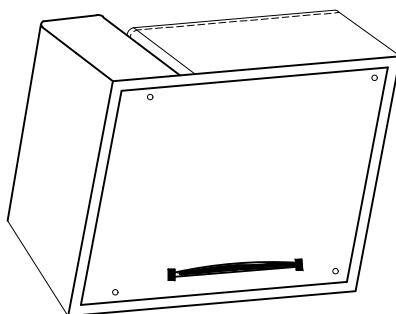

② : ARMLESS CHAIR

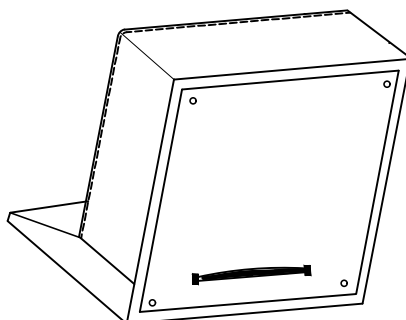

③ : WEDGE CHAIR

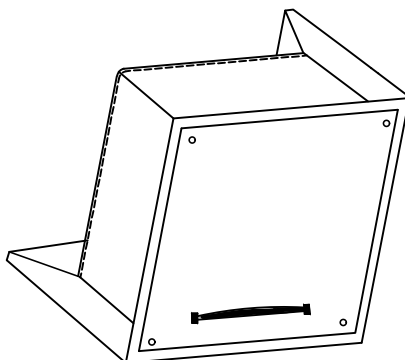

④ : OTTOMAN

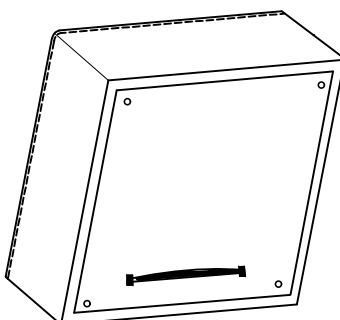

STEP 1 : With 2 People Carefully Turn Lounge Over onto a Sheet or a piece of cardboard
Unzip and remove the parts from the dust cover underneath the sofa.

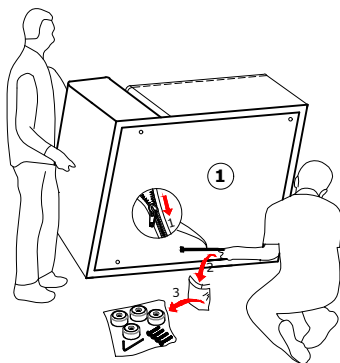

STEP 2 : With 2 People Carefully Turn Lounge Over onto a Sheet or a piece of cardboard
Unzip and remove the parts from the dust cover underneath the sofa.

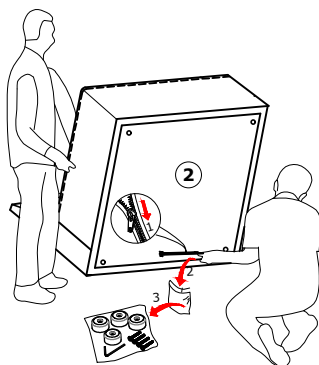

STEP 3 : With 2 People Carefully Turn Lounge Over onto a Sheet or a piece of cardboard
Unzip and remove the parts from the dust cover underneath the sofa.

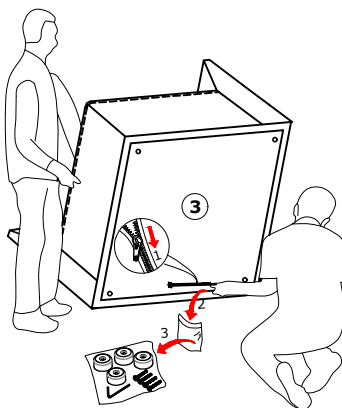

STEP 4 : With 2 People Carefully Turn Lounge Over onto a Sheet or a piece of cardboard
Unzip and remove the parts from the dust cover underneath the Ottoman.

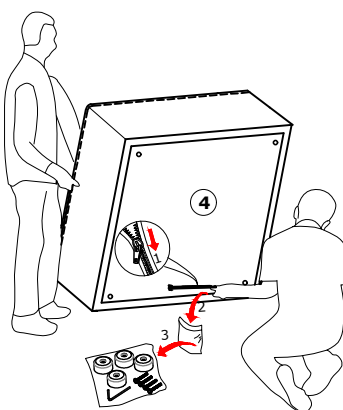

STEP 5 : Tighten the feet (C) to the sofa (1) with bolts (A) with tool (B)

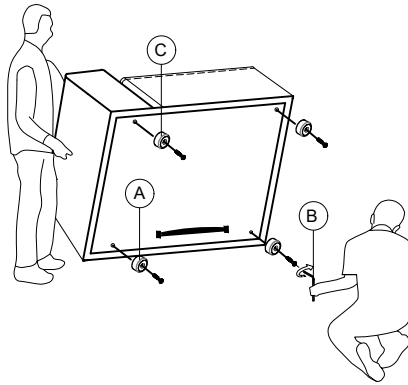

With 1 People Carefully Turn Sofa Back Over

STEP 6 : Tighten the feet (C) to the sofa (2) with bolts (A) with tool (B)

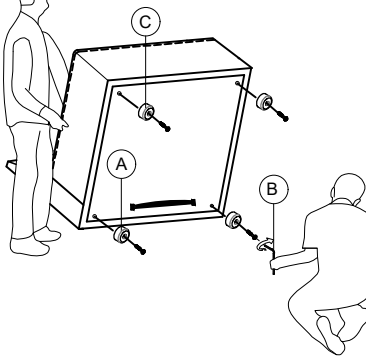

With 1 People Carefully Turn Sofa Back Over

STEP 7 : Tighten the feet (C) to the sofa (3) with bolts (A) with tool (B)

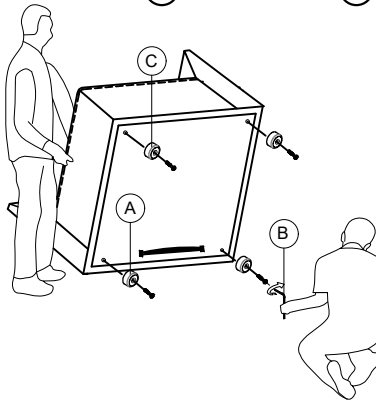

With 1 People Carefully Turn Sofa Back Over

STEP 8 : Tighten the feet (C) to the sofa (4) with bolts (A) with tool (B)

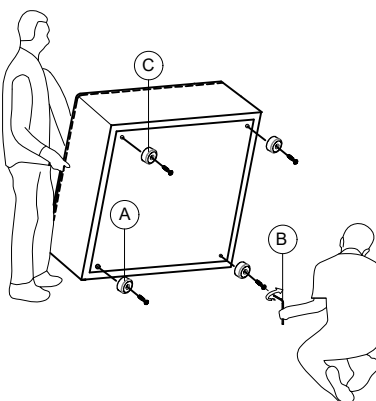

With 1 People Carefully Turn Sofa Back Over

STEP 9 : Attach the chaise to the sofa with the connectors.

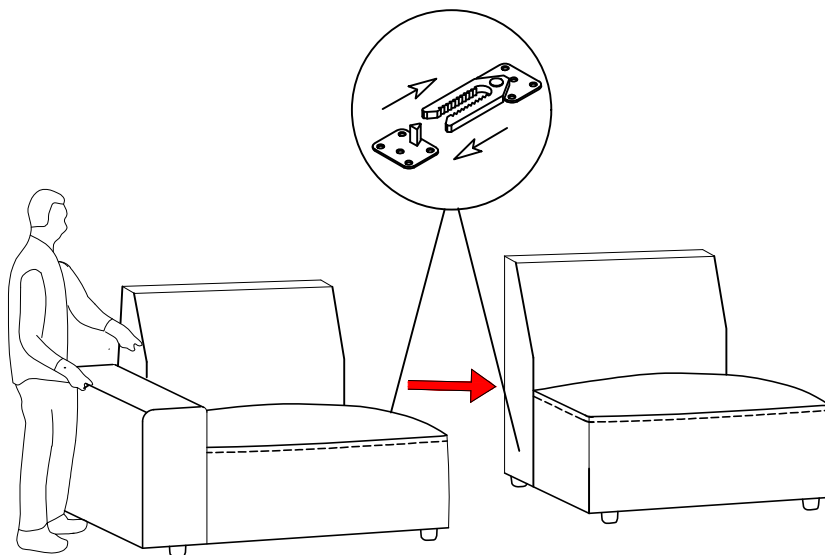

STEP 10 : Attach the chaise to the sofa with the connectors.

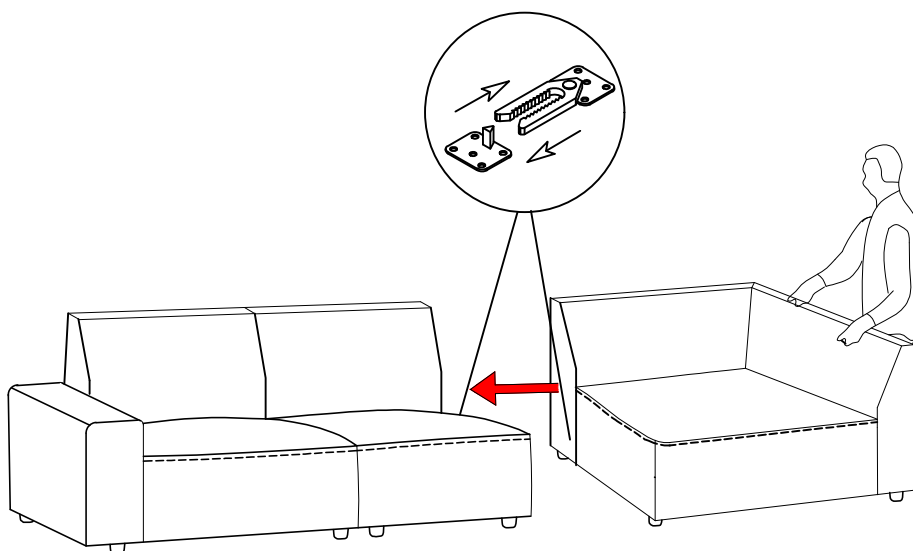

STEP 11 : Attach the chaise to the sofa with the connectors.

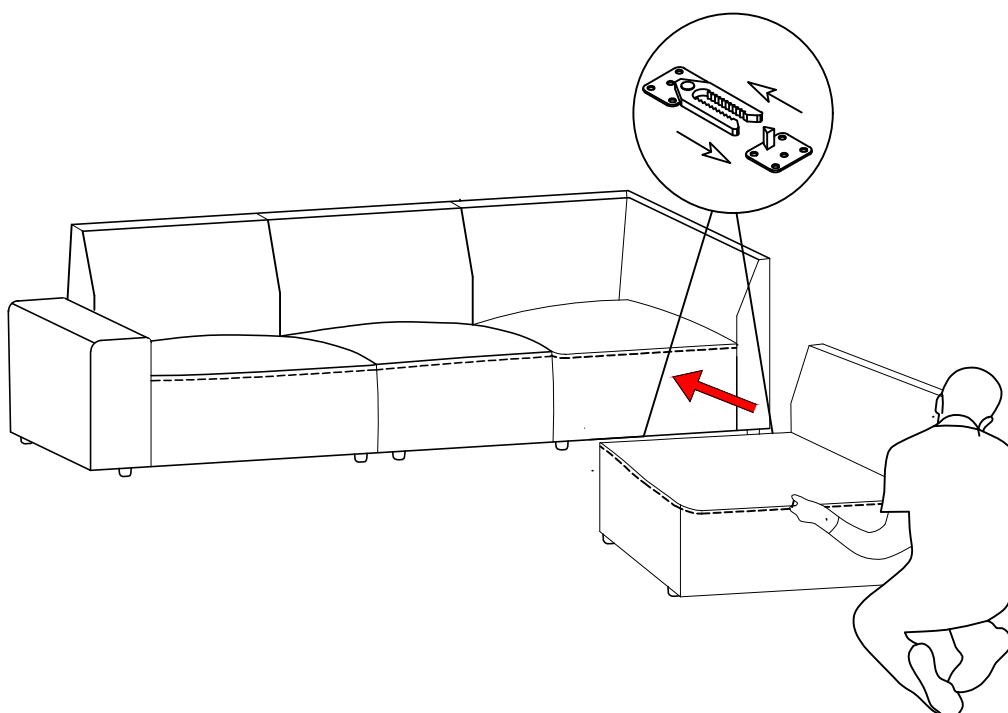

STEP 12 : Attach the chaise to the sofa with the connectors.

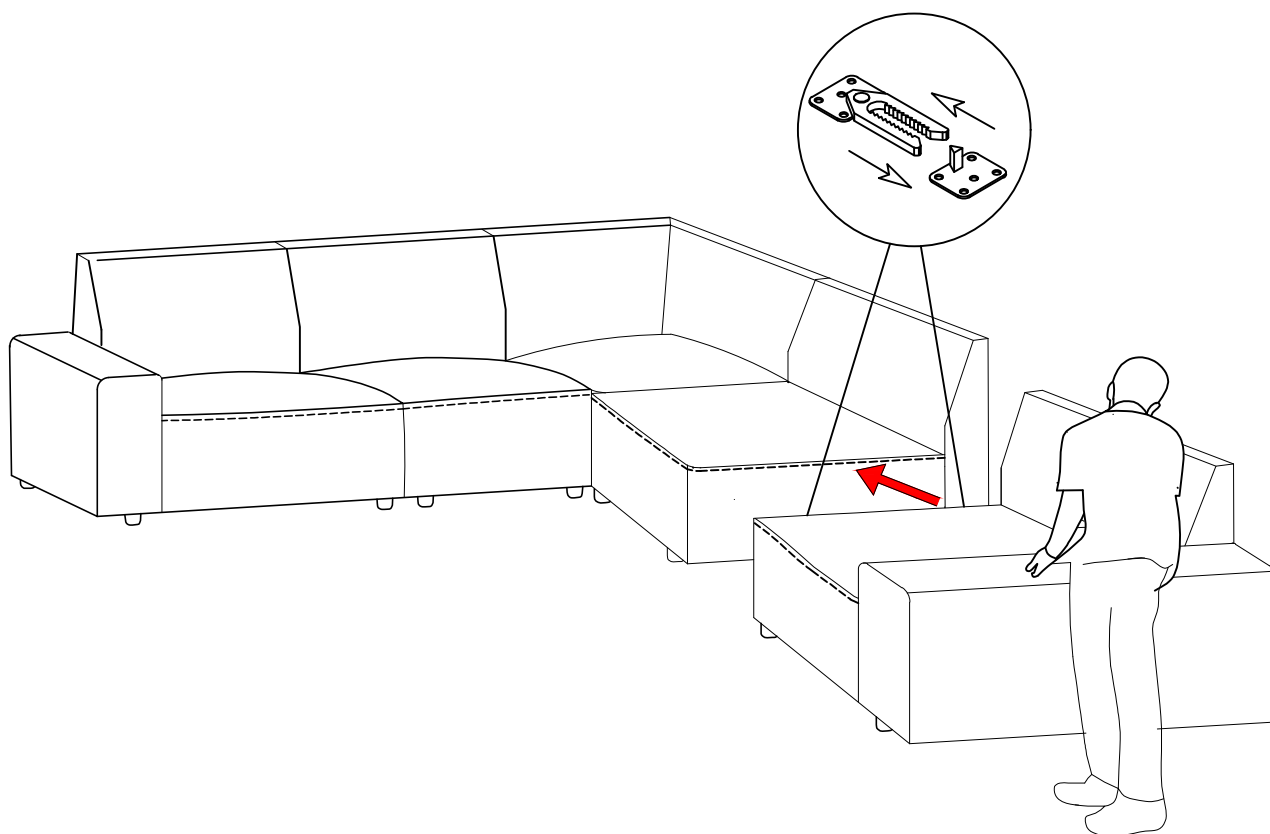

STEP 13 : Assembly is complete.

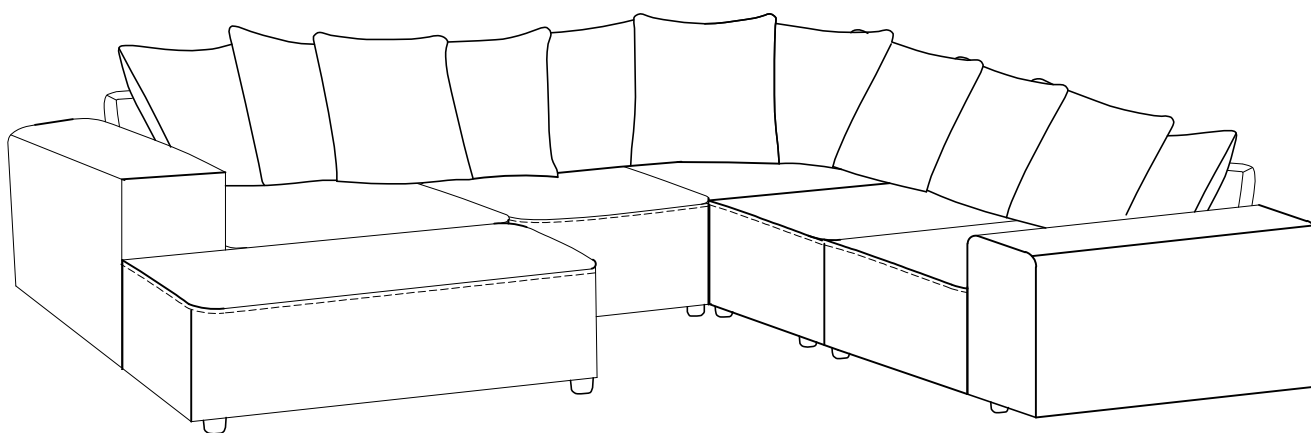

CARE AND MAINTENANCE

FABRIC CARE (SEAT AND SCATTER CUSHIONS)

REGULAR CARE: PROTECT FROM DIRECT SUNLIGHT.
VACUUM REGULARLY USING LOW SUCTION.
ROTATE REVERSIBLE CUSHIONS REGULARLY.

CLEANING:

DO NOT REMOVE CUSHION COVERS FOR SEPARATE
CLEANING EVEN THOUGH THEY HAVE ZIPPERS.
DO NOT WASH
DO NOT DRY CLEAN
DO NOT SHAMPOO CLEAN
CLEAN WITH HOT-WATER EXTRACTION MACHINE.
(HOT) PROFESSIONAL CLEANING RECOMMENDED
DO NOT USE DISHWASHING OR LAUNDRY
DETERGENTS
USE ONLY UPHOLSTERY DETERGENTS
DO NOT WET FILLING
DRY IN SHADE AWAY FROM DIRECT HEAT AND
SUNLIGHT
ALLOW TO DRY THOROUGHLY BEFORE RE-USE

SPOT CLEANING:

DO NOT RUB
DO NOT SPOT CLEAN WITH ANY SOLVENT.
TREAT SPILLS AND STAINS AS SOON AS POSSIBLE.
GENTLY SCRAPE ANY SOIL OR MOP ANY LIQUID
FROM THE SURFACE OF THE FABRIC.
APPLY PROPRIETARY CLEANING AGENTS STRICTLY
ACCORDING TO INSTRUCTIONS TO REMOVE THE
RESIDUE OF THE SPILL.
DO NOT SATURATE THE FABRIC OR INTERIOR WITH
WATER OR OTHER CLEANING LIQUIDS.

WARNING: APPLY ONLY WATER-BASED SOIL RESIST
(FABRIC PROTECTION) TREATMENTS. DO NOT USE
AEROSOL PRODUCTS.